

TLI-1550A

- > RECHARGEABLE
- > Up to 5000 cycles
- > Extremely low self discharge rate
- > Charging possible at extreme temperatures

Performance Data

(Typical values for batteries stored at +25 °C for one year)

System	Lithium Intercalated Compounds	
Nominal voltage	4 V	
Max. capacity	330 mAh	
Max. continuous discharge current	2 A	
Pulse current capability	5 A	
Discharge end voltage	2.5 V	
Max. charge voltage	4.1 V	
Max. charge current	100 mA	20 mA
Temperature range	-20 °C ... +50 °C	-40 °C ... +85 °C
Cell impedance @ 1 kHz, RT	max. 100 mΩ	
Nominal energy	max. 1.0 Wh	
Weight	20 g	

For more information please refer to page 46.



TLI-1550A/S

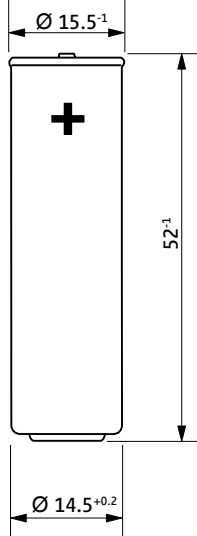

TLI-1550A/Z2/T

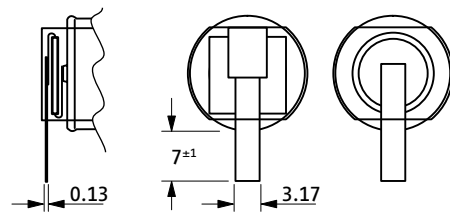

TLI-1550A/Z2/TP

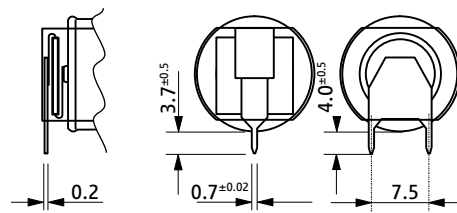

Discharge Curve at 25 °C

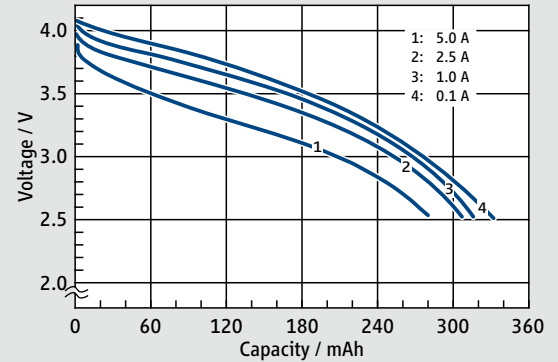

Discharge Curve at 2 A

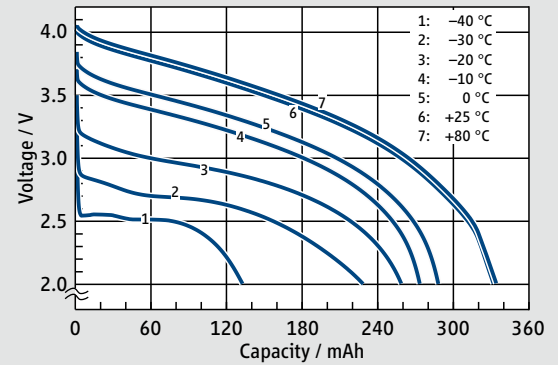

Cycling Performance

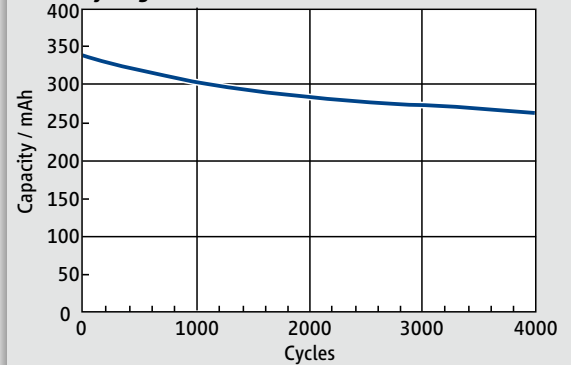

Available Terminations

Termination	Standard	Catalogue No.
TLI-1550A/S	Standard	13 2 11551 02
TLI-1550A/Z2/T	Tags	13 3 11552 02
TLI-1550A/Z2/TP	Polarized tags	13 3 11557 02

Warning:
 Fire, explosion,
 and severe burn hazards.
 Do not disassemble, heat
 above 100 °C, short circuit,
 incinerate or expose
 contents to water.

Do not charge above 4.1 V.
 Please refer to TLI-guidelines.